

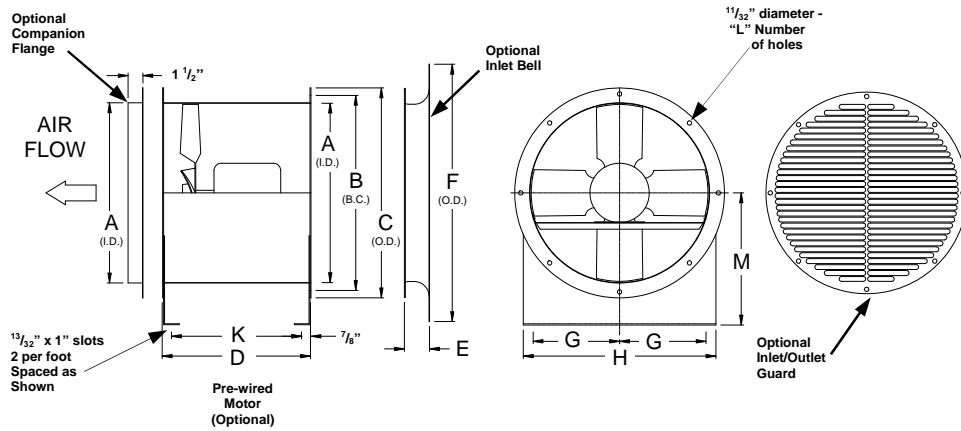

Type **TEBH** and **TEDH** Duct Fans

**T
E
D
H**



Fan Size	A	B	C	D	E	F	G	H	K	L	M	Casing Gage	Outlet Area
12	12 1/8	13 1/8	14	14	2	18	4 3/4	11 1/2	12 1/4	8	9 5/16	18	0.80
16	16 1/8	17 3/8	18 1/4	14	2	22	5 15/16	13 7/8	12 1/4	8	11 5/16	14	1.42
18	18 1/8	19 3/8	20 3/8	16	2	24	6 3/4	15 1/2	14 1/4	8	13 5/16	14	1.79
24	24 1/8	25 1/2	26 1/2	20 1/2	2	30	6 1/4	14 1/2	18 3/4	12	16 5/16	14	3.17

Dimensions in inches

**T
E
B
H**

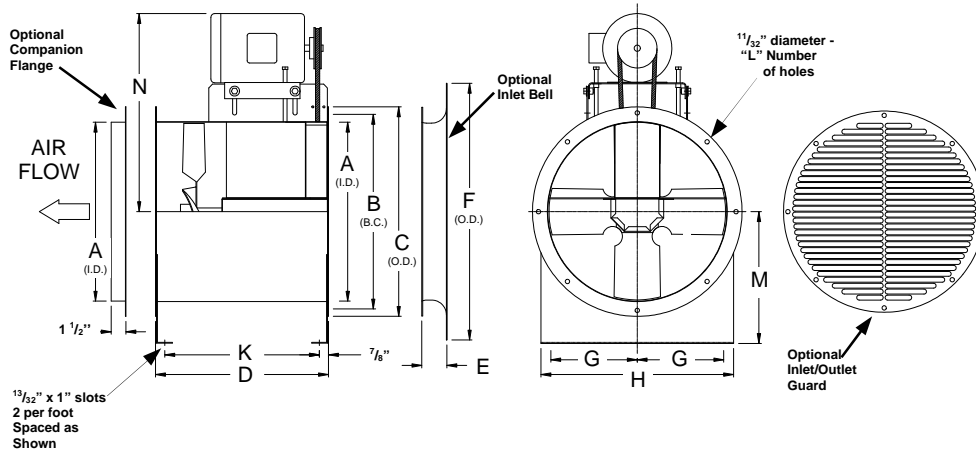

Fan Size	A	B	C	D	E	F	G	H	K	L	M	N	Casing Gauge	Outlet Area
12	12 1/8	13 1/8	14	12	2	18	4 3/4	11 1/2	10 1/4	8	9 5/16	17	18	0.80
16	16 1/8	17 3/8	18 1/4	16 1/2	2	22	5 15/16	13 7/8	14 3/4	8	11 5/16	20	14	1.42
18	18 1/8	19 1/2	20 3/8	16 1/2	2	24	6 3/4	15 1/2	14 3/4	8	13 5/16	21	14	1.79
24	24 1/8	25 1/2	26 1/2	20 3/4	2	30	6 1/4	14 1/2	19	12	16 5/16	27	14	3.17

Dimensions in inches

Application

Type TEBH and TEDH fans are suited to meet your ducted fan needs both economically and efficiently. They are designed to operate reliably in all environments including elevated temperature (TEBH) or contaminated air (TEBH).

Construction

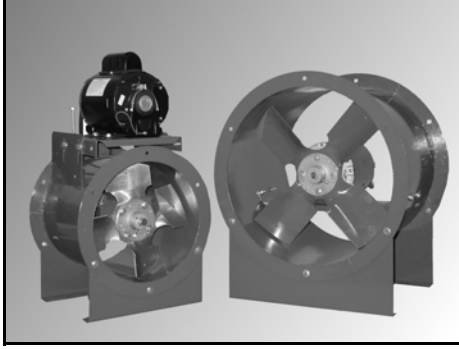

The fan housing and motor supports are made of heavy gauge steel plate for maximum strength and durability. Die-formed aluminum blades are standard; steel blades are optional. Painted parts are coated with epoxy to provide a protective coating rated excellent for hardness, impact resistance, adhesion and chemical resistance. Contact factory for protective coating options.

Drive mechanism

BELT DRIVE: Available in sizes 12 inch to 24 inch. Belt driven models are designed for quieter operation and lower initial cost. They use standardly available 1750 RPM motors.

DIRECT DRIVE: Available in sizes 12 inch to 24 inch. Direct driven models require less maintenance, offer longer operating life, increased efficiency and reduced operating cost.

TEBH Performance Ratings

Item No.	Cubic Feet Per Minute (CFM) at Static Pressure									Fan Model	Fan Size	Motor HP	Fan RPM	Sone Rating	Max BHP
	0"	1/8"	1/4"	3/8"	1/2"	5/8"	3/4"	1"	1 1/4"						
1	1480	1391	1291	1173	987	---	---	---	---	TEBH12G	12	1/4	2232	19.1	0.25
2	1626	1546	1458	1359	1238	1044	---	---	---	TEBH12H		1/3	2452	22	0.33
3	1863	1793	1719	1639	1551	1448	1305	---	---	TEBH12J		1/2	2809	28	0.50
4	2133	2072	2009	1942	1872	1796	1711	1473	---	TEBH12K		3/4	3216	34	0.75
5	2517	2359	2157	1854	---	---	---	---	---	TEBH16G	16	1/4	1508	16.9	0.25
6	2754	2612	2441	2213	1862	---	---	---	---	TEBH16H		1/3	1650	19.8	0.33
7	3163	3042	2904	2740	2532	2242	---	---	---	TEBH16J		1/2	1895	25	0.50
8	3641	3537	3423	3296	3149	2974	2753	---	---	TEBH16K		3/4	2181	31	0.75
9	3984	3890	3789	3678	3555	3416	3253	2805	---	TEBH16L		1	2387	37	1.00
10	3411	3166	2896	2559	---	---	---	---	---	TEBH18H	18	1/3	1444	19.2	0.33
11	3917	3705	3479	3230	2923	---	---	---	---	TEBH18J		1/2	1658	25	0.50
12	4496	4313	4120	3918	3697	3437	---	---	---	TEBH18K		3/4	1903	32	0.75
13	4952	4786	4614	4434	4245	4040	3802	---	---	TEBH18L		1	2096	35	1.00
14	5663	5519	5370	5217	5059	4894	4720	4313	---	TEBH18M		1 1/2	2397	44	1.50
15	5262	4712	4093	---	---	---	---	---	---	TEBH24H	24	1/3	1031	19.4	0.33
16	5967	5483	4978	4338	---	---	---	---	---	TEBH24J		1/2	1169	24	0.50
17	6824	6402	5972	5505	4911	---	---	---	---	TEBH24K		3/4	1337	32	0.75
18	7493	7109	6720	6317	5856	5282	---	---	---	TEBH24L		1	1468	38	1.00
19	8631	8299	7963	7622	7269	6879	6417	---	---	TEBH24M		1 1/2	1691	47	1.50
20	9438	9134	8827	8518	8204	7875	7514	6619	---	TEBH24N		2	1849	54	2.00
21	10795	10530	10263	9994	9723	9449	9167	8543	7773	TEBH24P		3	2115	69	3.00

TEDH Performance Ratings

Item No.	Cubic Feet Per Minute (CFM) at Static Pressure									Fan Model	Fan Size	Motor HP	Fan RPM	Sone Rating	Max BHP
	0"	1/8"	1/4"	3/8"	1/2"	5/8"	3/4"	1"	1 1/4"						
1	823	677	---	---	---	---	---	---	---	TEDH12H11	12	1/3	1190	8.2	0.04
2	1191	1101	991	861	---	---	---	---	---	TEDH12F17		1/6	1725	18.7	0.12
3	2300	2262	2221	2178	2132	2083	2031	1914	1783	TEDH12K34		3/4	3475	51	0.90
4	2011	1782	1499	---	---	---	---	---	---	TEDH16H11	16	1/3	1180	10.5	0.12
5	2863	2708	2541	2360	2146	1886	---	---	---	TEDH16H16		1/3	1680	22	0.37
6	2803	2508	2117	1001	---	---	---	---	---	TEDH18H11	18	1/3	1170	10.7	0.18
7	4157	3965	3761	3538	3268	2933	2450	---	---	TEDH18J17		1/2	1735	23	0.61
8	5971	5474	4872	4296	---	---	---	---	---	TEDH24H11	24	1/3	1130	21	0.45
9	9038	8703	8370	8040	7705	7337	6884	5887	---	TEDH24M17		1 1/2	1750	46	1.69