

TYPE - FM STIR FANS

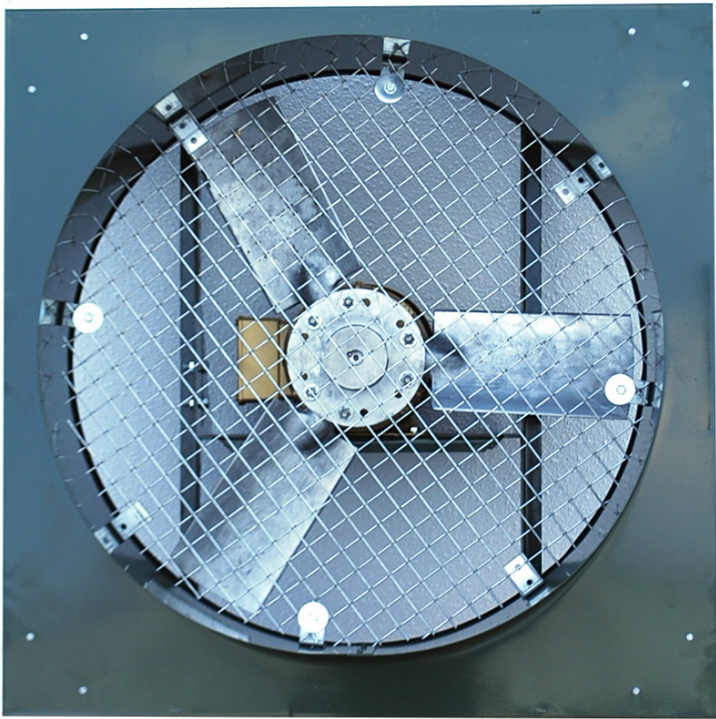

FM MODEL OVERVIEW

Type - FM fans are direct drive models that can be used for spot cooling, manure drying, or general mixing of air with their high velocity discharge.

Type-FM 18 features galvanized construction, equipped with an aluminum blade assembly and a single-phase 1/3 HP motor.

Type-FM 24 features epoxy coated steel construction, and features cast aluminum blades and a three-phase 1 HP motor.

Accessories

- Factory mounted front safety guard
- Hanging bracket

PERFORMANCE RATINGS

Fan Model	Speed RPM	Air Flow CFM	Power W	5D Centerline Vel. fpm
FM18H16	1,672	4,029	445	1,166
FM24L17	1,773	8,163	781	1,730

DRAWINGS & DIMENSIONS

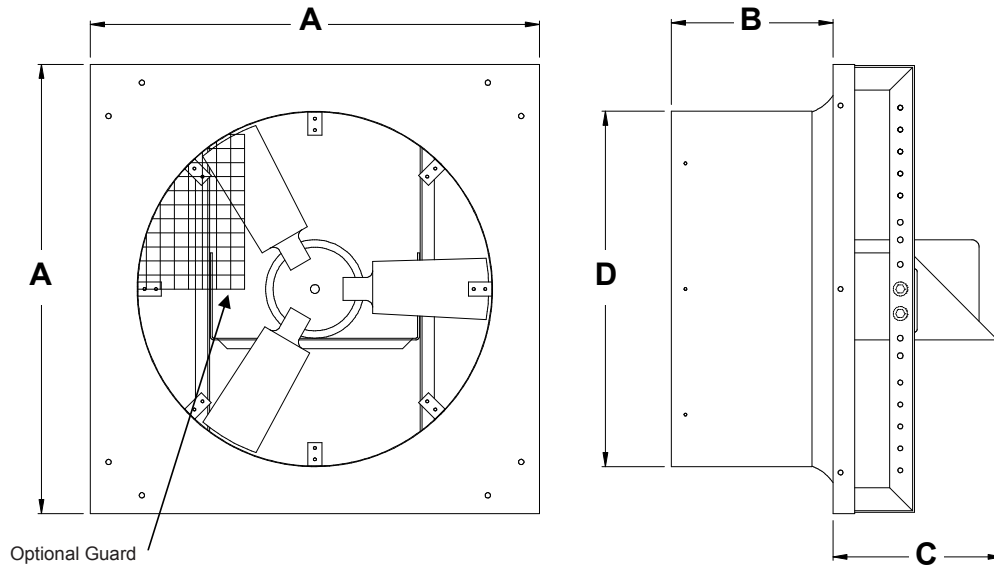

Fan Size	A	B	C	D
18	23 13/16	6	6 11/16	18 7/8
24	32	11 1/2	12 1/2	25 1/4



P.O. Box 2300 | Jacksonville, FL 32203
 Ph 904-389-3646
 Fax 904-387-3449 | 904-381-7560
 www.coolair.com
 Member of AMCA International

/AmericanCoolair

/AmericanCoolair

/Company/American-Coolair-Corp